

“low profile“ Sockets & Strips

Low profile DIP sockets LOP Series

height above PCB 2.41mm / .095"

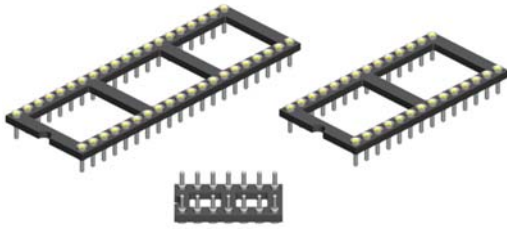

Low profile strips SLP Series

height above PCB 2.41mm / .095"

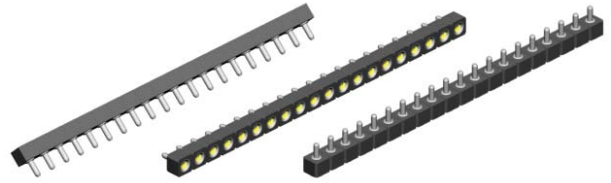

Insulator

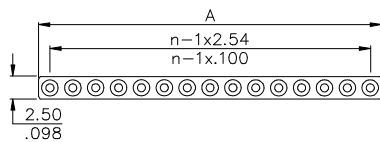
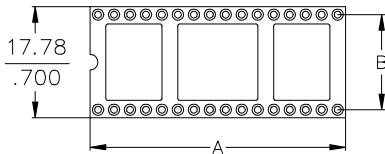
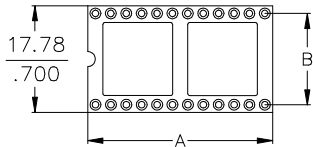
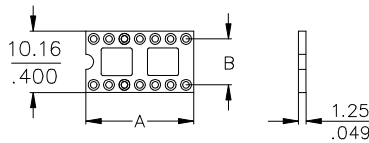

Pin	Dimensions mm/inch		Ordering Code
	"A"	"B"	
14	17,78/.700	7,62 .300	LOP - 314 - S083 - 95
16	20,32/.800		LOP - 316 - S083 - 95
18	22,86/.900		LOP - 318 - S083 - 95
20	25,40/1.000		LOP - 320 - S083 - 95
24	30,48/1.200		LOP - 324 - S083 - 95
		15,24 .600	
24	30,48/1.200		LOP - 624 - S083 - 95
28	35,56/1.400		LOP - 628 - S083 - 95
		15,24 .600	
32	40,64/1.600		LOP - 632 - S083 - 95
40	50,80/2.000		LOP - 640 - S083 - 95
10	25,40/1.000		SLP - 110 - S083 - 95
14	35,56/1.400		SLP - 114 - S083 - 95

Other sizes and flush head version on request

Pin-outs

Other pin-outs available on request.

Despite the very low profile of these sockets the IC legs can be inserted completely.

Recommended PCB Layout

Recommended drilling hole dia Ø 0,8mm/.031"

Low Profile Terminal

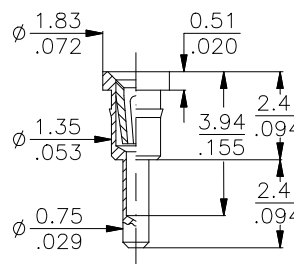

083 2.41mm / .095" over PCB

Plating

Standard:

- **95** = tin/gold
(tin leadfree)

Alternative

- **55** = gold/gold
- **99** = tin/ tin
(leadfree)

Specifications

Mechanical data

Insertion force 1,80 N (avg)
Extraction force 0,90 N (avg)
Contact life > 100 cycles
Solderability as per IEC 60068-2-58
Contact security:
-Vibration as per EN60352-4
-Shock as per EN60352-4

Material

Insulator *(RoHS compliant)* PBT UL 94 V-0
Terminal *(RoHS compliant)* CuZn
Contact *(RoHS compliant)* BeCu

Electrical data

Contact resistance at 1A 4,3 mΩ typ.
Current rating 1A max., 100V
Contact capacitance at 1MHz 2 pF max.
Insulation resistance at 500V DC 5 × 10⁹ Ω min.
Breakdown voltage at 60 Hz 500 V AC
Contact resistance ≤ 7 mΩ

Operating temperature

-55° C to +125° C

Pitch

2,54 mm (.100")

More information, for example about testresult please ref. to page 49 or contact E-tec.