

# Mini DIN Connector straight "THT" Type

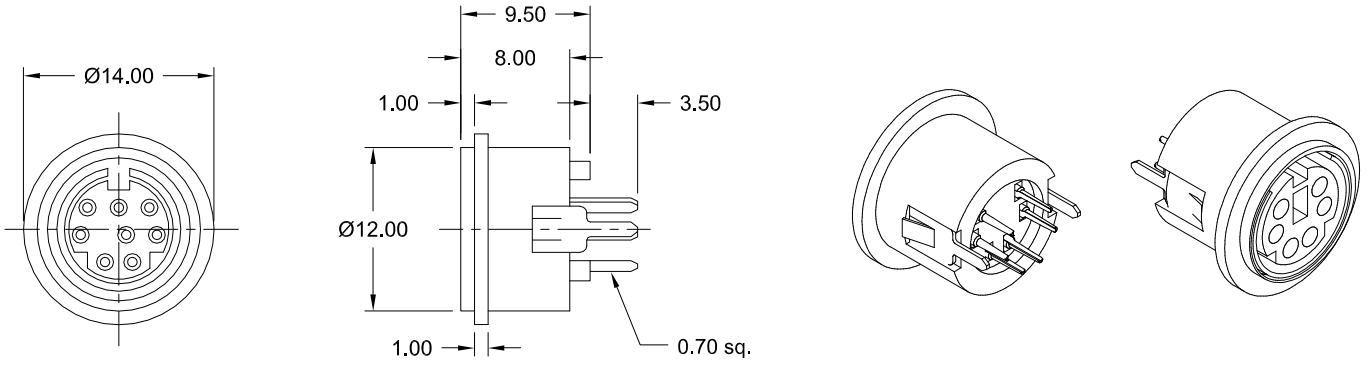

Front View

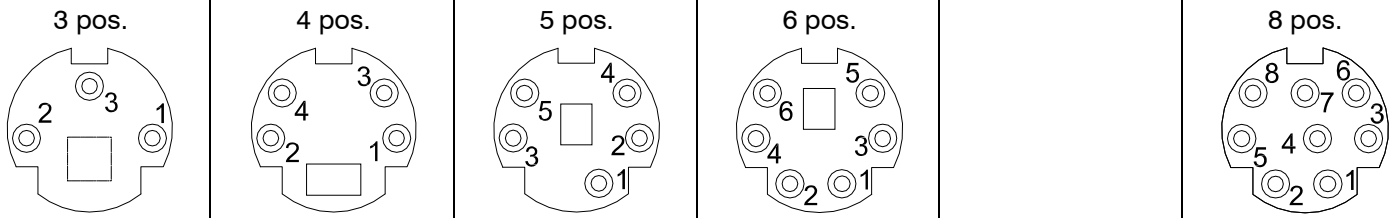

PCB through hole Layout (Top View)

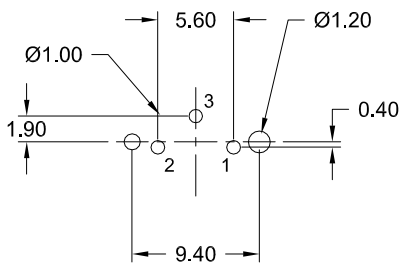

3 pos.

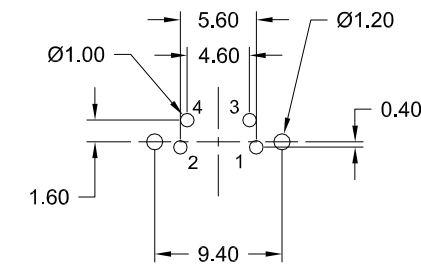

4 pos.

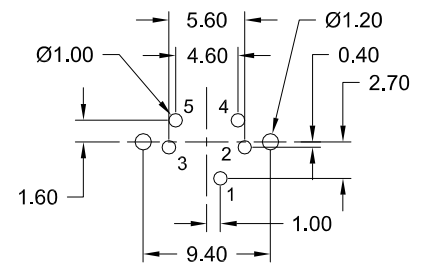

5 pos.

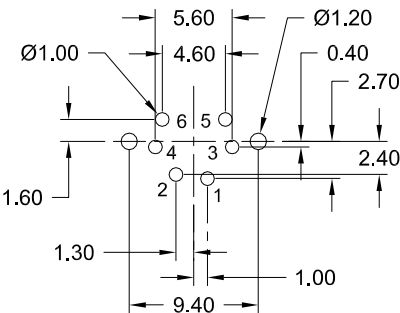

6 pos.

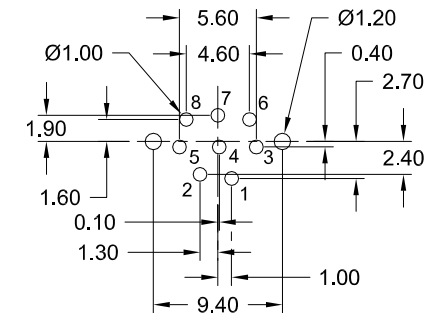

8 pos.

## SPECIFICATIONS

Current rating	1 A max. at 100 V AC or 2 A max. at 12 V DC	Contact material	(RoHS compliant)	PhBz; Silver plated
Insulation resistance	100 MΩ min. at 500 V DC	Ground Terminal material	(RoHS compliant)	Brass; Tin plated
Contact resistance	30 mΩ max.	Insulator material	(RoHS compliant)	P.B.T. UL 94 V-0
Dielectric withstanding voltage	250 V AC for 1 min.	Insertion force		39N max.
Operating temperature	-40°C to +105°C	Extraction force		8,8N min.
		Insertion/extraction cycles		100 min.

## Ordering Code

**MDJ - xxx - SN01 - AGZ**

<b>Nbr of contacts</b>
<b>003; 004; 005</b>
<b>006; 008</b>