

**Analog & Digital Type**

with plastic pegs

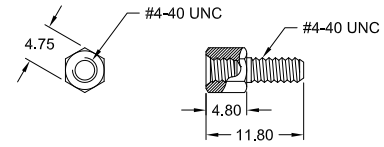
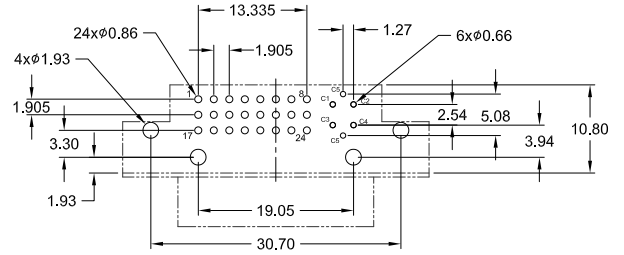
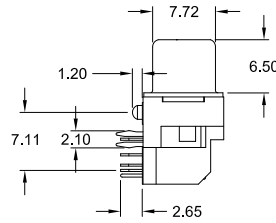
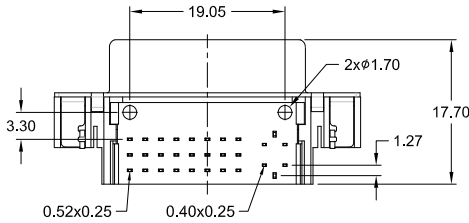
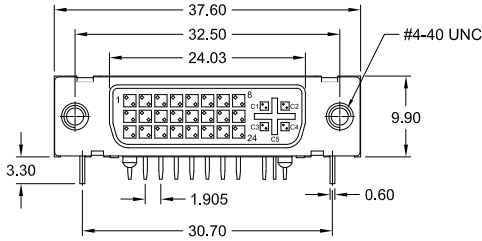

Option: Jack Screw

**Specifications**

<b>Electrical:</b>	
Current rating	1.5 A min.
Insulator resistance	1000 M Ω min.
Contact resistance	20 m Ω max.
Dielectric strength	1000 V for 1 Min.
Withstanding voltage	500V (rms) AC 1 Min.
Operating temperature	-20° C to +85° C
<b>Mechanical:</b>	
Insertion force	4.5 Kg max.
Withdrawal force	1.0 Kg min.
Durability	100 Cycles
<b>Material:</b>	
Contact	Copper Alloy
Housing	PBT UL 94V-0
Latch	PA66 UL 94V-0
Shell	Steel; Ni plated

**How to order**

**DVF - 029 - NAD9 - xx /W P X**

Plating	
<b>95</b>	= Tin (leadfree) / Gold flash
<b>97</b>	= Tin (leadfree) / Gold 15μ"
<b>98</b>	= Tin (leadfree) / Gold 30μ"

Housing Color	
<b>W</b>	= white (standard)
<b>B</b>	= black (option)

Option	
<b>J</b>	
2 Jack Screws 4-40 UNC attached	

**Digital Type**

without plastic pegs

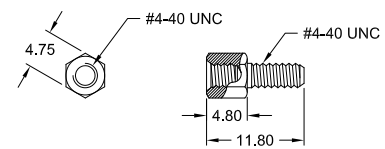
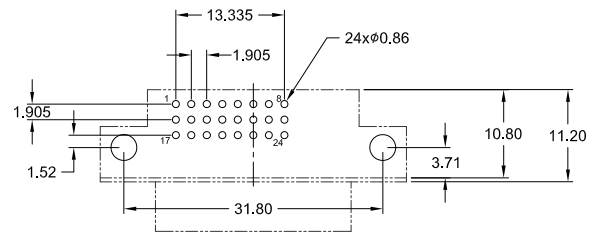
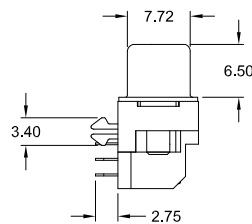
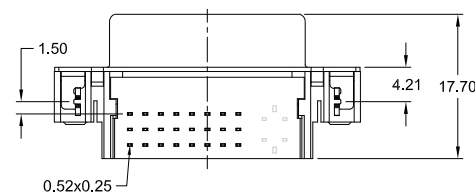
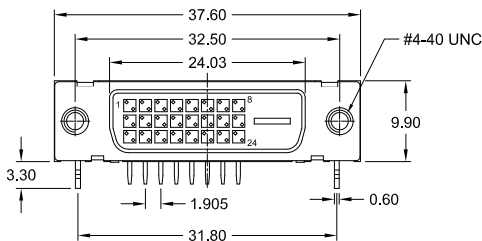

Option: Jack Screw

**Specifications**

<b>Electrical:</b>	
Current rating	1.5 A min.
Insulator resistance	1000 M Ω min.
Contact resistance	20 m Ω max.
Dielectric strength	1000 V for 1 Min.
Withstanding voltage	500V (rms) AC 1 Min.
Operating temperature	-20° C to +85° C
<b>Mechanical:</b>	
Insertion force	4.5 Kg max.
Withdrawal force	1.0 Kg min.
Durability	100 Cycles
<b>Material:</b>	
Contact	Copper Alloy
Housing	PBT UL 94V-0
Latch	PA66 UL 94V-0
Shell	Steel; Ni plated

**How to order**

**DVF - 024 - NDD9 - xx /W P X**

Plating	
<b>95</b>	= Tin (leadfree) / Gold flash
<b>97</b>	= Tin (leadfree) / Gold 15μ"
<b>98</b>	= Tin (leadfree) / Gold 30μ"

Housing Color	
<b>W</b>	= white (standard)
<b>B</b>	= black (option)

Option	
<b>J</b>	
2 Jack Screws 4-40 UNC attached	